

INSPECTION

1. INSPECT WIPER AND WASHER SWITCH CONTINUITY

Switch position	Tester connection	Specified condition
OFF	7 – 16	Continuity
INT	7 – 16	Continuity
LO	7 – 17	Continuity
HI	8 – 17	Continuity
Washer OFF	–	No continuity
Washer ON	2 – 11	Continuity

If continuity is not as specified, replace the switch.

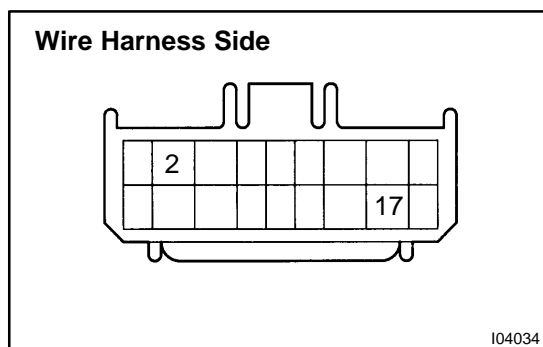

2. Connector disconnected: INSPECT WIPER AND WASHER SWITCH CIRCUIT

Disconnect the connector from the motor and inspect the connector on the wire harness side, as shown.

Tester connection	Condition	Specified condition
2 – Ground	Constant	Continuity
17 – Ground	Ignition switch LOCK or ACC	No voltage
17 – Ground	Ignition switch ON	Battery positive voltage

If circuit is not as specified, inspect the circuits connected to other parts.

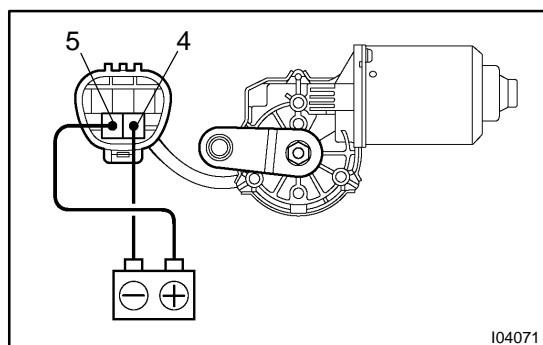

3. Low speed: INSPECT WIPER MOTOR OPERATION

Connect the positive (+) lead from the battery to terminal 5 and the negative (–) lead to terminal 4, check that the motor operates at low speed.

If operation is not as specified, replace the motor.

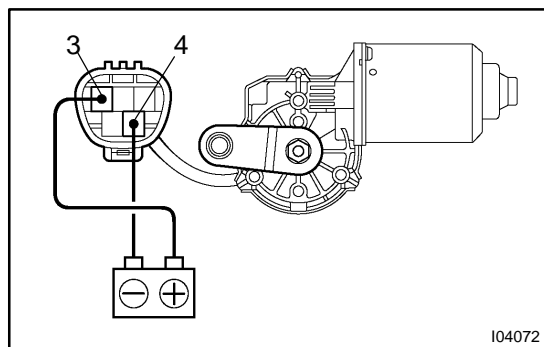

4. High speed:
INSPECT WIPER MOTOR OPERATION

Connect the positive (+) lead from the battery to terminal 3 and the negative (–) lead to terminal 4, check that the motor operates at high speed.

If operation is not as specified, replace the motor.

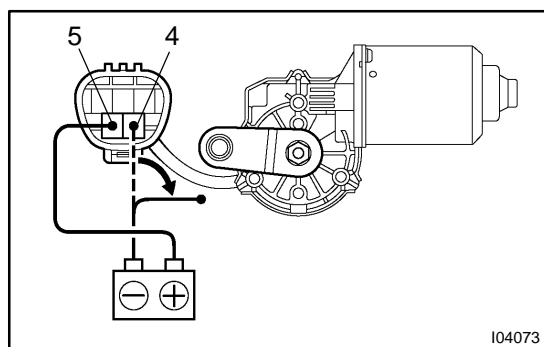

5. Stopping at stop position:
INSPECT WIPER MOTOR OPERATION

(a) Operate the motor at low speed and stop the motor operation anywhere except at the stop position by disconnecting positive (+) lead from terminal 5.

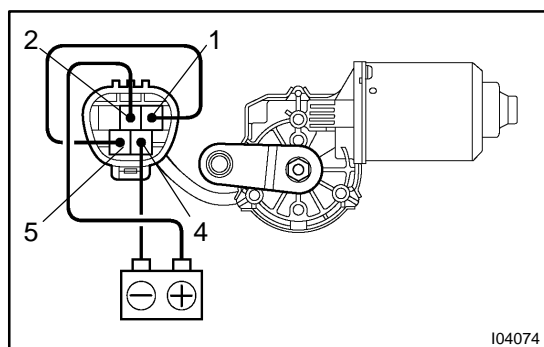

(b) Connect terminals 1 and 5.

(c) Connect the positive (+) lead from the battery to terminal 2 and negative (–) lead to terminal 4, check that the motor stops running at the stop position after the motor operates again.

If operation is not as specified, replace the motor.

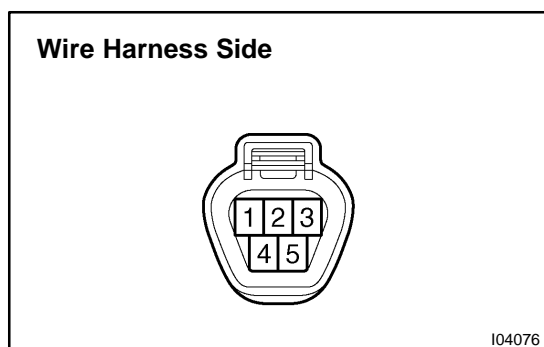

6. Connector disconnected:
INSPECT WIPER MOTOR CIRCUIT

Disconnect the connector from the motor and inspect the connector on the wire harness side, as shown.

Tester connection	Condition	Specified condition
4 – Ground	Constant	Continuity
2 – Ground	Ignition switch LOCK or ACC	No voltage
2 – Ground	Ignition switch ON	Battery positive voltage

If circuit is not as specified, inspect the circuits connected to other parts.

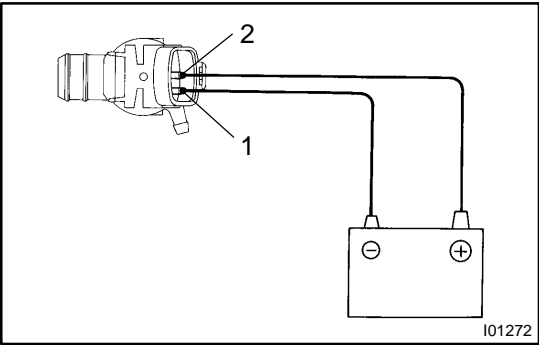

7. INSPECT WASHER MOTOR OPERATION

Connect the positive (+) lead from the battery to terminal 2 and the negative (-) lead to terminal 1, check that the motor operates.

NOTICE:

These tests must be performed quickly (within 20 seconds) to prevent the coil from burning out.

If operation is not as specified, replace the motor.

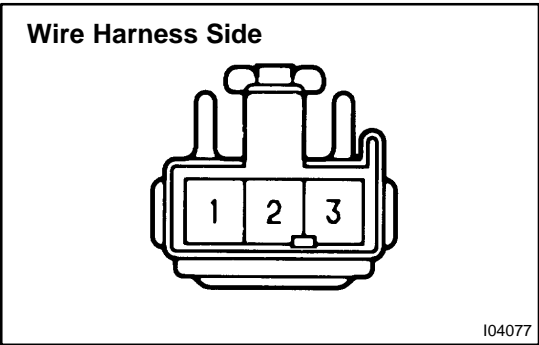

8. Connector disconnected:

INSPECT WASHER MOTOR CIRCUIT

Disconnect the connector from the motor and inspect the connector on the wire harness side, as shown.

Tester connection	Condition	Specified condition
2 – Ground	Ignition switch ON	Battery positive voltage

If circuit is not as specified, inspect the power source, wire harness and wiper switch.